

AP. 2 CAMERE  
S=51,10 mp

Parter ap. 1, 4

Parter ap. 1, 4

**APARTAMENT 2 CAMERE**

LIVING	19,20 mp
BUCATARIE	8,30 mp
DORMITOR	12,90 mp
BAIE	4,50 mp
HOL	6,20 mp

**SUPRAFATA UTILA 51,10 mp**

BALCON 6,00 mp

**TOTAL 57,10 mp**

SUPRAFETELE SUNT CALCULATE LA ROSU SI NU INCLUD ERORILE DE EXECUTIE

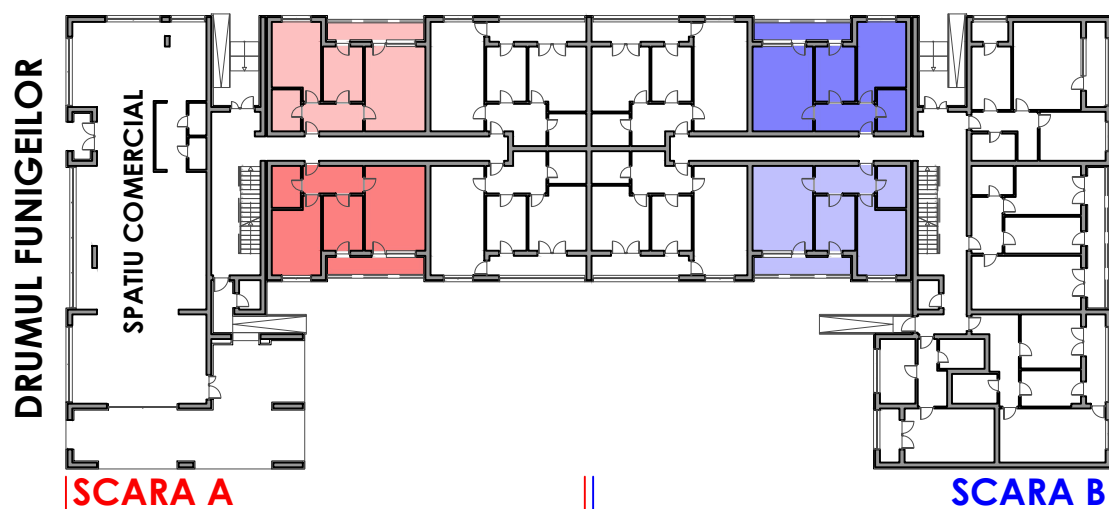
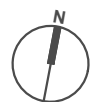

**BLOC 1**